

NO.	DATE	REVISIONS

WOMER AND ASSOCIATES INC.
 Architecture Engineering Planning Environmental Services
 Suite 600 - 221 N. WALI ST., Spokane, Washington 99201
 TEL: (509) 534-4854 FAX: (509) 534-4843 WWW: WWW.WAI.COM

KITITAS FIRE PROTECTION DISTRICT #6
 RONALD, WASHINGTON
 EROSION CONTROL

PROJECT NO.	
DATE	
SCALE	

ESC1.0



EXISTING UTILITIES AND LOCATIONS SHOWN ARE NOT TO SCALE. THE CONTRACTOR MUST VERIFY ALL FIELD LOCATIONS. INFORMATION PROVIDED BY THE RESPECTIVE UTILITIES.

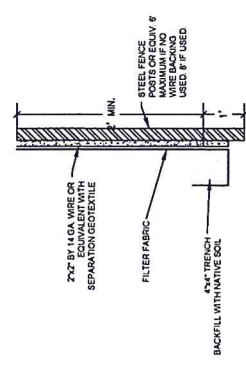
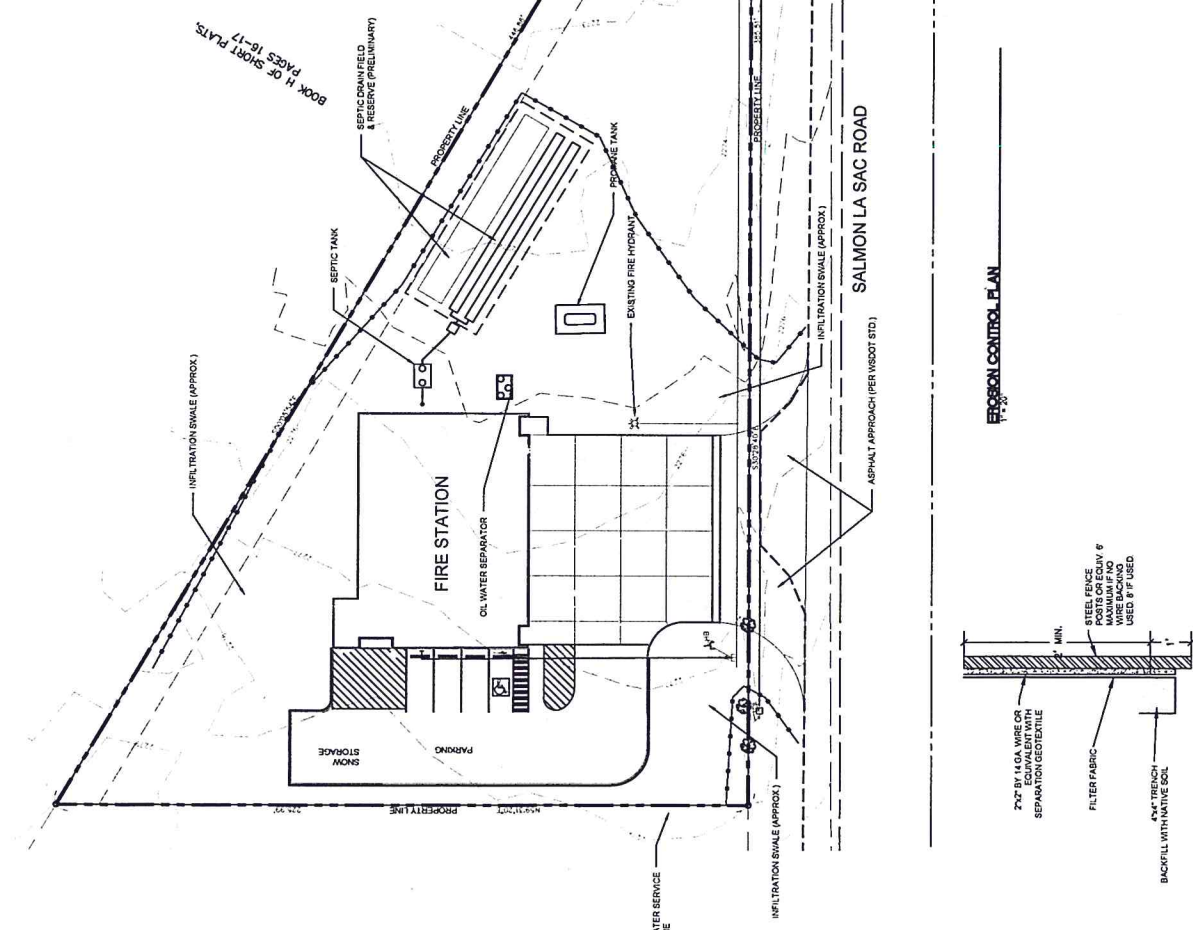
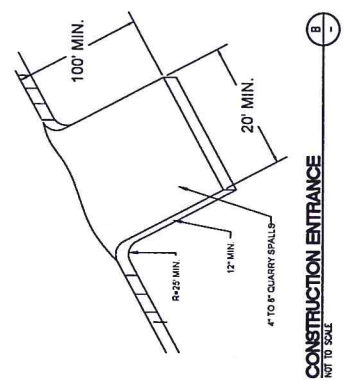
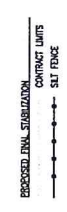

GENERAL NOTES:

HYDROSEED OR COVER TOPSOIL STOCKPILES TO PREVENT EROSION FROM WIND AND RAIN.

EROSION CONTROL NOTES:

- THE ENTRANCE SHALL BE MAINTAINED IN A CONDITION WHICH WILL PREVENT TRACKING OF MUD ONTO PUBLIC RIGHT OF WAY. THIS SHALL BE ACCOMPLISHED BY THE CONTRACTOR THROUGH THE USE OF STRUCTURE, VEHICLES DIRT TRACKING ONTO ROADWAYS OR INTO STORM DRAINS MUST BE REMOVED IMMEDIATELY.
- ALL TEMPORARY EROSION AND SEDIMENT CONTROL MEASURES SHALL BE MAINTAINED THROUGHOUT CONSTRUCTION. WHEN STABILIZATION IS ACHIEVED, OR AFTER THE TEMPORARY BMP'S ARE REMOVED, AN EROSION CONTROL PLAN SHALL BE SUBMITTED FOR PERMANENTLY STABILIZED.
- COORDINATE PLAN WITH DEMOLITION, GRADING, DRAINAGE AND SITE PLAN, FOR CONSTRUCTION OF DRY WELLS, INSTALL AND MAINTAIN PERMANENT DRAINAGE SYSTEMS, BETWEEN THE WASHED DRAIN ROCK AND THE NATIVE SOILS.
- IMPLEMENTATION OF THE EROSION SEDIMENTATION CONTROL (ESC) PLAN, AND CONSTRUCTION, MAINTENANCE, AND UPGRADES OF THE ESC, SHALL BE COMPLETED BY THE END OF CONSTRUCTION.
- THE EROSION/SEDIMENTATION CONTROL MEASURES SHOWN ARE THE MINIMUM REQUIREMENTS FOR THE ANTICIPATED SITE. THE CONTRACTOR SHALL BE RESPONSIBLE FOR IDENTIFYING AND MAINTAINING THESE ESC MEASURES DURING CONSTRUCTION AND SHALL MAINTAIN AND UPGRADE THESE MEASURES AS NECESSARY TO PREVENT SEDIMENT-LOADED RUNOFF FROM THE SITE. THE CONTRACTOR SHALL BE RESPONSIBLE FOR IDENTIFYING AND MAINTAINING NEW/EXISTING STORM DRAINAGE FACILITIES SUCH AS DRYWELLS, CULVERTS, OR GRAVEL GALLERIES.
- THE CONTRACTOR IS RESPONSIBLE FOR INSTALLING ROCK CONSTRUCTION ENTRANCES AT ANY AND ALL LOCATIONS USED TO ENTER OR EXIT THE PROJECT SITE.
- CONTRACTOR TO REMOVE ANY ACCUMULATED SEDIMENT FROM SPACES, CHANNELS, AND STRUCTURES.

SEEDING NOTES:

MINIMUM SEEDING REQUIREMENTS TO OCCUR IN THE MONTHS OF SEPTEMBER THROUGH OCTOBER. SEEDING TO OCCUR WITHIN 30 DAYS AFTER CONSTRUCTION TAKES PLACE, TO BE AS FOLLOWS:

- SIBERIAN WHEAT \$4.6 POUNDS/ACRE
- CRESTED WHEAT \$2.5 POUNDS/ACRE
- HYPER FESCUE \$4.6 POUNDS/ACRE
- SHARP FESCUE \$4.6 POUNDS/ACRE
- BIG BLUE GRASS \$4.6 POUNDS/ACRE

NOTE: SEEDING CAN ALSO OCCUR IN FALL MONTHS SEPT. THROUGH OCT. 15

PRELIMINARY